

PRODUCTS

VENMAR COMMERCIAL HRVs

Heat-recovery ventilators transfer heat from outgoing ventilation air to the incoming air during heating season; in cooling season, the reverse. Venmar offers a variety of indoor and outdoor HRVs from 300 to 11,500 CFM with three types of ARI-certified flat plate heat exchangers: polypropylene for corrosive applications, aluminum that meets NFPA-90A, and their HM (heat moisture) membrane to provide both sensible and latent recovery—temperature and moisture—for high humidity applications (especially in dry, cool climates). > **Venmar CES Inc.**; **Saskatoon, SK, Canada. 306-242-3663, 866-483-6627; www.venmarces.com CIRCLE 102**



HYDRORIGHT DUAL-FLUSH CONVERTER

Except for a dwindling few cranks, everybody agrees that dual-flush toilets are a good idea. Four-fifths of the time there's only liquid and paper in the bowl, and you don't need a tank-full of water to make that go away. The biggest hurdle to upgrading may be popping for a new toilet while the old water-hog is still working. While replacement is still the best option, that excuse no longer works. For less than \$30, the HydroRight can turn any existing toilet with a standard flush valve into a dual-flush toilet. Regular people can install one in about ten minutes. > **MJSI, Inc.**; **Shorewood, IL. 815-741-9768; www.gomjsi.com CIRCLE 104**



COSENTINO ECO COUNTERTOPS

Eco by Cosentino is a countertop surfacing made with 75 percent post-consumer/post-industrial raw materials—the most recycled content for this type of product on the market, according to the company. Mirrors, glass, porcelain, crystallized ash, stone scrap, and a binder made with 22 percent corn oil resin give the look and performance of quartz composite and natural stone. Stain, scratch, and scorch resistant, non-porous, and certified by Greenguard for low emissions, Eco comes in 63x128-inch slabs, and 12-, 18-, and 24-inch square tiles. Available at kitchen and bath distributors and showrooms, and at Lowes. > **Cosentino North America**; **Stafford, TX. 281-494-7277, 800-291-1311; www.cosentinonorthamerica.com CIRCLE 105**



PENTADYNE FLYWHEEL ENERGY STORAGE

Imagine a levitating carbon fiber cylinder spinning in a vacuum: It would be virtually friction-free. This is part of the technology Pentadyne uses in its Flywheel Energy Storage system, used primarily with large uninterruptible power supplies in place of hazardous, maintenance-needy, heavy lead-acid batteries for mission-critical electrical loads at commercial, industrial, hospital, and military facilities. The inertia of the flywheel is used to regenerate clean power until the backup generators kick in during an outage or during brief utility disturbances. Their installed systems have surpassed two million hours of operation. > **Pentadyne Power Corporation**; **Chatsworth, CA. 818-350-0370; www.pentadyne.com CIRCLE 103**

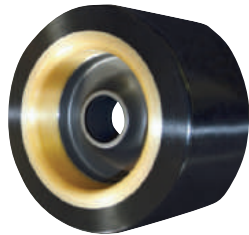

JM SPIDER CUSTOM INSULATION

Johns Manville's Spider Custom Insulation is a formaldehyde-free, spray-applied fiberglass insulation for commercial or residential walls and ceilings. It has a polyester-based binder, and when applied with 10 percent or less moisture content can be covered immediately. At 1.0 or 1.8 pounds per cubic foot densities, R-values are about 3.7 or 4.2 per inch, respectively. According to the company it fills gaps and won't settle, and can also be formulated for attic and drill-and-fill installations. SCS-certified for 25-percent recycled content (20 percent post-consumer), it also passes California 01350 for low-emissions. A proprietary mold inhibitor is used in this product. > **Johns Manville Corporation**; **Denver, CO. 303-978-2000, 800-654-3103; www.jm.com CIRCLE 106**